



REMOTE LIGHTING LIFTER

BEK
Schréder



REMOTE LIGHTING LIFTER



BS-PSI-20/30

BS-PFI-100

DIMENSIONS IN MM

BS-PSI-20/30

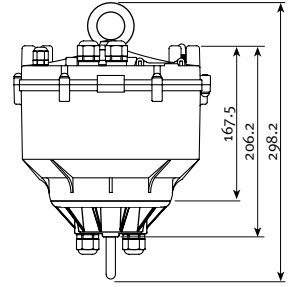
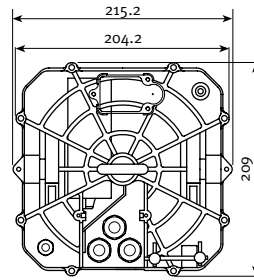

BS-PFI-100

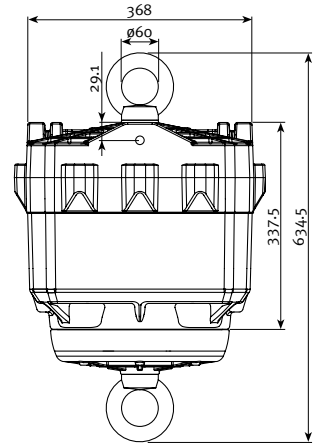
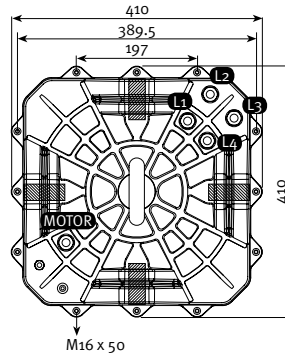

APPLICATIONS

- Warehouses
- Factories
- Shopping malls
- Hotels
- Sport centres
- Hangars

KEY ADVANTAGES

- Cost-effective maintenance solution for luminaires

PRODUCT SPECIFICATIONS

	BS-PSI-20/30	BS-PFI-100
Operating voltage and frequency	100-277V AC/50-60Hz	220V-240V AC/50-60HZ
Ambient temperature	-15°C to 60°C	-15°C to 60°C
Ingress protection	IP 54	IP 54
Suspension cable	1	4
Lamp capacity (circuit 1)	16A	16A

ORDERING DATA

DESCRIPTION	MAX. LOADING WEIGHT (KG)	UNIT WEIGHT (KG)	MAX. LOWERING HEIGHT (M)
BS-PSI-20	7 - 20	8.7	20
BS-PSI-30	12 - 30	8.7	15
BS-PFI-100	50 - 100	54	30

WIRELESS CONTROL



The remote control handset enables convenient control of up to 999 lifts per group.

BEKA Schröder (Pty) Ltd - South Africa
Manufacturers of Luminaires and Glass Fibre Poles

11/14



BEKA Schröder (Pty) Ltd | 13 West View Road | P.O. Box 120 | Olifantsfontein | 1665 | South Africa

T: +27 11 238 0000 | F: +27 11 238 0180

info@beka-schreder.co.za | www.beka-schreder.co.za

